

## Flush Bezel (accessories) For LB/A6, LW Series Switches & Pilot Lights

ø16 mm LB/A6 series become ø22 mm flush silhouette switches.  
ø22 mm LW series become ø30 mm flush silhouette switches.  
Panel cut-out compliant with IEC standards.

### Applicable Models—round bezels only

| Series    | LB   | A6  | LW   |
|-----------|--|---|--|
| Functions | Illuminated pushbutton<br>Pilot light<br>Pushbutton<br>Selector switch<br>Key selector switch<br>Illuminated selector switch<br>Lever switch<br>Buzzer | Illuminated pushbutton<br>Pilot light<br>Pushbutton<br>Selector switch<br>Key selector switch | Illuminated pushbutton<br>Pilot light<br>Pushbutton<br>Selector switch<br>Key selector switch<br>Illuminated selector switch<br>Buzzer |



| Shape                    | Material  | Bezel Color | Ordering No.           | Remarks   |
|--------------------------|---|-------------|------------------------|---|
| For ø16 LB/A6 series<br> | Adapter: polyamide<br>Rubber gasket: nitril rubber<br>Mounting bracket: stainless steel | Black       | <b>LB9Z-AS61B (*1)</b> | Degree of protection: IP65<br>(when used with IP65 units) |
|                          |   | Metallic    | <b>LB9Z-ASM61 (*1)</b> |   |
| For ø22 LW series<br>    | Adapter: polyamide<br>Rubber gasket: nitril rubber<br>Locking ring: polyamide           | Black       | <b>LW9Z-AS61B</b>      |   |
|                          |   | Metallic    | <b>LW9Z-ASM61</b>      |   |

\*1) Use **LB9Z-AS62B** (black) or **LB9Z-ASM62** (metallic) bezels when mounting in a panel from 2 to 3.6 mm thick.

### Dimensions

#### For ø16 mm LB/A6 (**LB9Z-AS61B/LB9Z-ASM61**)

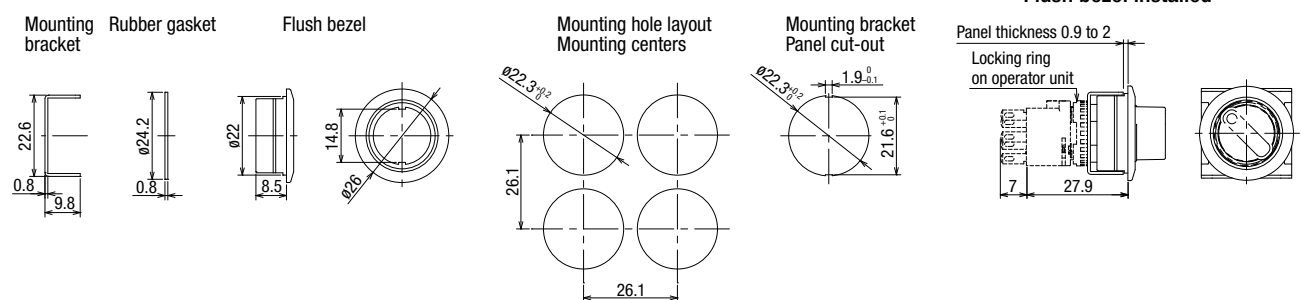

#### For ø22 mm LW (**LW9Z-AS61B/LW9Z-ASM61**)

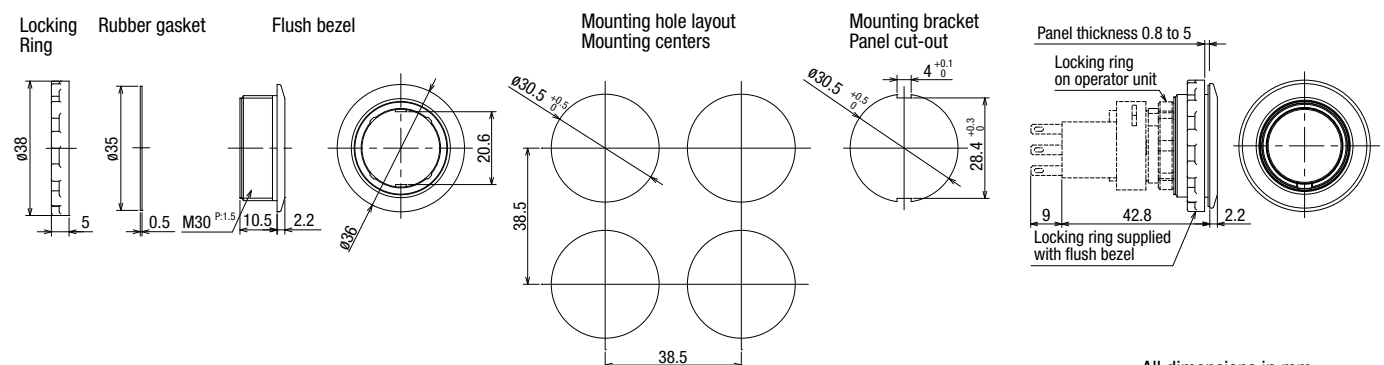

All dimensions in mm.

## Safety Precautions

- Turn off the power before installation, removal, wiring, maintenance, and inspection. Failure to turn power off may cause electrical shocks or fire hazard.
- LED lamp/LED unit is hot right after the power has turned off. To avoid burning your hand, make sure the temperature has dropped sufficiently. Use the lamp holder tool when replacing the lamps.
- For wiring, use wires of a proper size to meet voltage and current requirements. Improper solder may cause overheating and create a fire hazard. Also, when using tab terminals, use receptacles of appropriate size.

## Operating Instructions

### ø22 mm flush bezel (for ø16 mm LB/A6 series)

#### Panel mounting

##### LB Series

1. Detach the operator unit from the contact block. To do so, turn the locking lever on the contact block in the direction opposite to the arrow on the housing.
2. Attach the rubber gasket to the flush bezel. Insert the LB series into the flush bezel and install the assembly on the panel. Attach the mounting bracket and tighten the locking ring. (Do not use the anti-rotation ring supplied with the operator.)
3. Install the contact block with the TOP markings on the contact block and the operator placed in the same direction, then lock the units by turning the locking lever in the direction of the arrow.

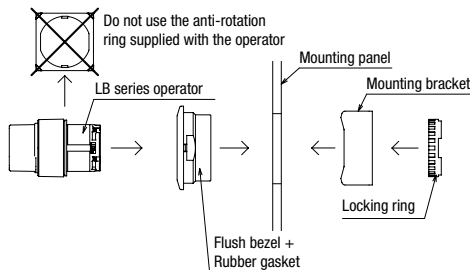

##### A6 Series

1. Remove the locking ring and anti-rotation ring.
2. Attach the rubber gasket to the flush bezel. Insert the A6 series into the flush bezel by placing the projection on the bezel to the groove on the TOP side of the operator, then install the assembly on the panel.
3. Attach the mounting bracket and tighten the locking ring. (Do not use the anti-rotation ring supplied with the operator.)

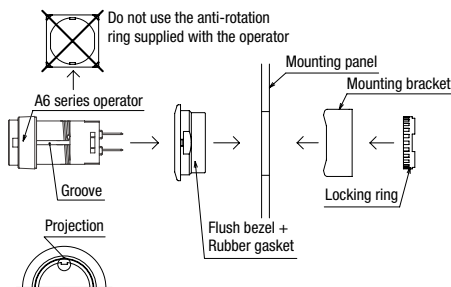

#### Notes on panel mounting

Use the optional ring wrench (MT-001) to mount the operator onto the panel. The recommended tightening torque is 0.5 to 0.7 N·m for LB series, and 0.88 N·m for A6 series. Do not use pliers. Excessive tightening will damage the locking ring.

### ø30 mm flush bezel (for ø22 mm LW series)

#### Panel mounting

1. Detach the operator unit from the contact block. To do so, turn the locking lever on the contact block in the direction opposite to the arrow on the housing. Remove the locking ring and anti-rotation ring (supplied on some models).
2. Attach the rubber gasket on the flush bezel. Install the bezel on the LW operator unit, and tighten using the locking ring which is supplied with the LW series. Use the optional ring wrench (LW9Z-T1) and tighten to a recommended torque of 1.2 N·m. Then install the unit onto the panel and tighten using the locking ring supplied with the flush bezel. (Do not use the anti-rotation ring supplied with the operator unit of some models.)
3. Insert the contact block with TOP markings on the contact block and the operator unit placed in the same direction. Then lock the units, turning the locking lever in the direction of the arrow.

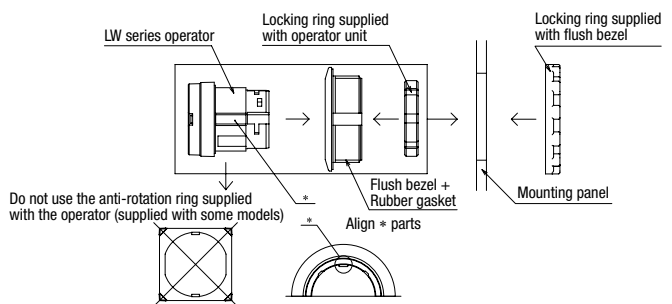

#### Notes on panel mounting

Use the optional ring wrench (XN9Z-T1) to mount the operator onto the panel. The recommended tightening torque is 1.8 to 2.0 N·m. Do not use pliers. Excessive tightening will damage the locking ring.

# IDEC CORPORATION

#### Head Office

6-64, Nishi-Miyahara-2-Chome, Yodogawa-ku, Osaka 532-0004, Japan

|                  |                               |                          |                      |
|------------------|-------------------------------|--------------------------|----------------------|
| <b>USA</b>       | IDEC Corporation              | Tel: +1-408-747-0550     | opencontact@idec.com |
| <b>Germany</b>   | IDEC Electrotechnik GmbH      | Tel: +49-40-25 30 54 - 0 | service@eu.idec.com  |
| <b>Singapore</b> | IDEC Izumi Asia Pte. Ltd.     | Tel: +65-6746-1155       | info@sg.idec.com     |
| <b>Thailand</b>  | IDEC Asia (Thailand) Co., Ltd | Tel: +66-2-392-9765      | sales@th.idec.com    |
| <b>Australia</b> | IDEC Australia Pty. Ltd.      | Tel: +61-3-8523-5900     | sales@au.idec.com    |
| <b>Taiwan</b>    | IDEC Taiwan Corporation       | Tel: +886-2-2698-3929    | service@tw.idec.com  |

|                       |                             |                        |                      |
|-----------------------|-----------------------------|------------------------|----------------------|
| <b>Hong Kong</b>      | IDEC Izumi (H.K.) Co., Ltd. | Tel: +852-2803-8989    | info@hk.idec.com     |
| <b>China/Shanghai</b> | IDEC (Shanghai) Corporation | Tel: +86-21-6135-1515  | idec@cn.idec.com     |
| <b>China/Shenzhen</b> | IDEC (Shenzhen) Corporation | Tel: +86-755-8356-2977 | idec@cn.idec.com     |
| <b>China/Beijing</b>  | IDEC (Beijing) Corporation  | Tel: +86-10-6581-6131  | idec@cn.idec.com     |
| <b>Japan</b>          | IDEC Corporation            | Tel: +81-6-6398-2527   | marketing@idec.co.jp |

 [www.idec.com](http://www.idec.com)